

GROUND FLOOR ACCOMMODATION:
 ANCILIARY RETAIL - USE CLASS A1 - 100SQM
 UNIVERSITY BOOKSHOP - USE CLASS A1 - 100SQM
 UNIVERSITY CAFE/Common ROOM - USE CLASS A3 - 150SQM
 ANCILIARY LEISURE (GYM ETC) - USE CLASS D2 - 200SQM
 UNIVESTITY OFFICE ACCOMMODATION - USE CLASS B1 - 300SQM

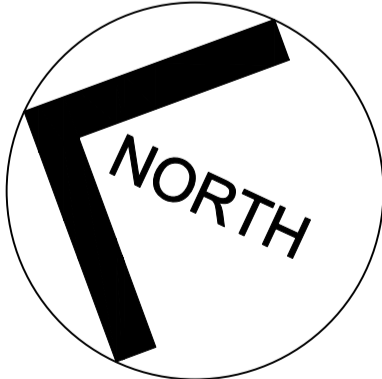

2 PODS/FLOOR - 16 BEDROOMS

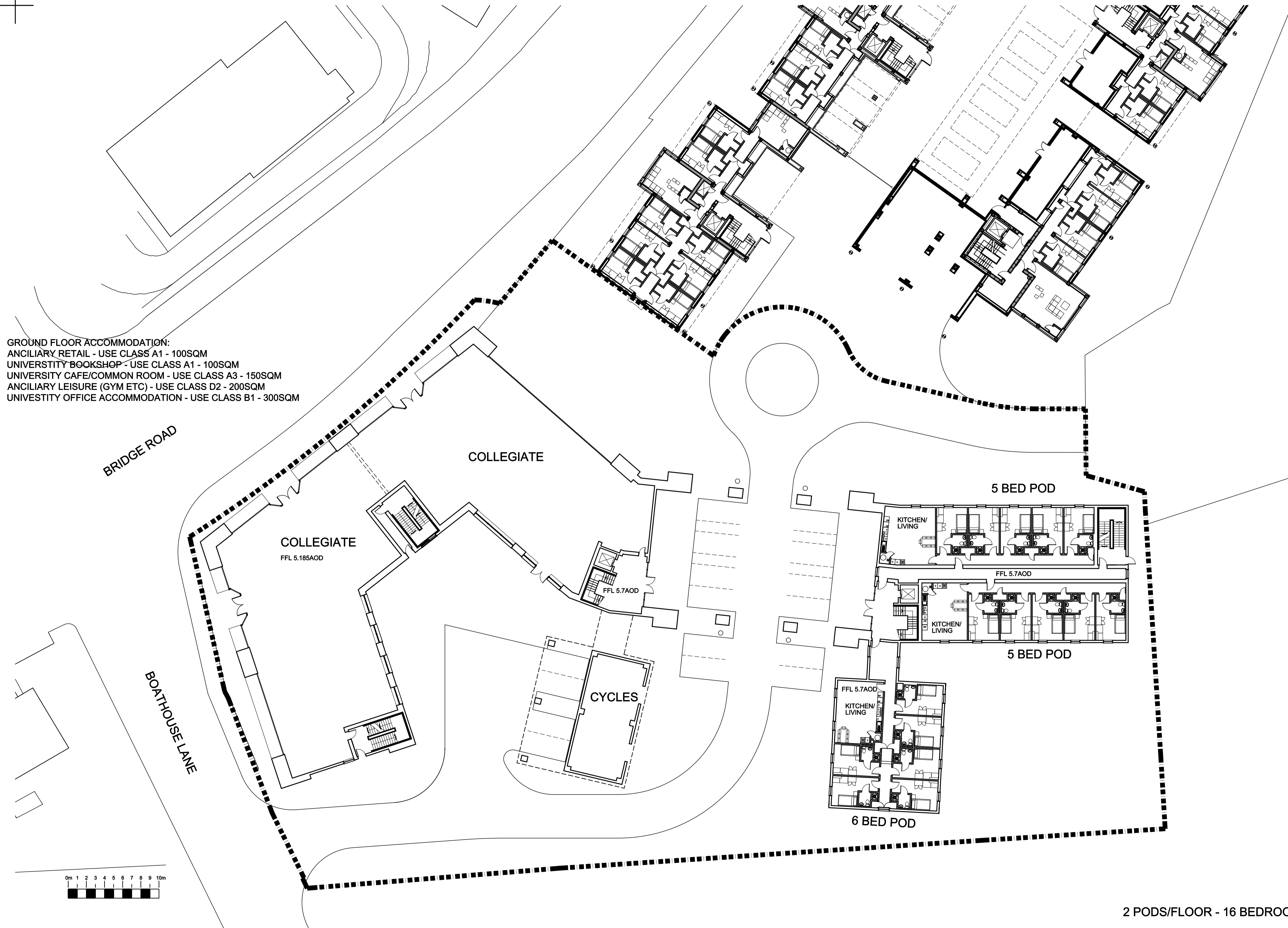

1 DO NOT SCALE THIS DRAWING 2 CHECK ALL DIMENSIONS ON SITE 3 COPYRIGHT IN THIS DRAWING AND ANY DESIGNS CONTAINED THEREIN ARE THE PROPERTY OF ELDERLESTER MCGREGOR ROSS CHARTERED ARCHITECTS AND MUST NOT BE COPIED WITHOUT WRITTEN AGREEMENT		F	20/06/08	BOUNDARY AMENDED	G	22/06/08	GROUND FLOOR ACCOMMODATION AMENDED	H	-/-/08	REVISION	I	11/08/08	FFL ADDED	
A	-/-/08	REVISION	B	12/05/08	CORNER + CORE AMENDED	C	27/05/08	REDRAWN	D	27/05/08	LINK AND LOBBY ADDED	E	-/-/08	REVISION

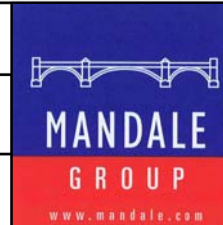

PROJECT:
 THE MANDALE GROUP
 STUDENT ACCOMMODATION
 BRIDGE ROAD
 PHASE 2
 STOCKTON ON TEES

DRAWING:
 PROPOSED GROUND FLOOR PLAN
 & SITE LAYOUT



SCALE: 1/200 @ A1
 PARTNER: I M MCGREGOR
 DATE FIRST PLOTTED: 30/04/08
 LAST PLOTTED: 11/08/2008
 DRAWING NO:
0722/L100i